

Lueders Larson Pool & Guest House
McLean, Virginia

Residential Architecture

Ten years after the completion of our clients' house, they came back to us asking for an outdoor world to complement it.

A pool, which had been discussed as part of the original design, pool/guest house and a courtyard with fire pit and pizza oven have been added to pull activities outside, taking advantage of a climate where 6 to 8 months per year can be comfortable outdoors.

Original house materials — stone, glass and wood — and their assembly details were mined to create the new structures, although in a looser, more casual way.

Finally, one plus one equals three in the creation of a carefully scaled courtyard between house and pool house — now the best room on the site.

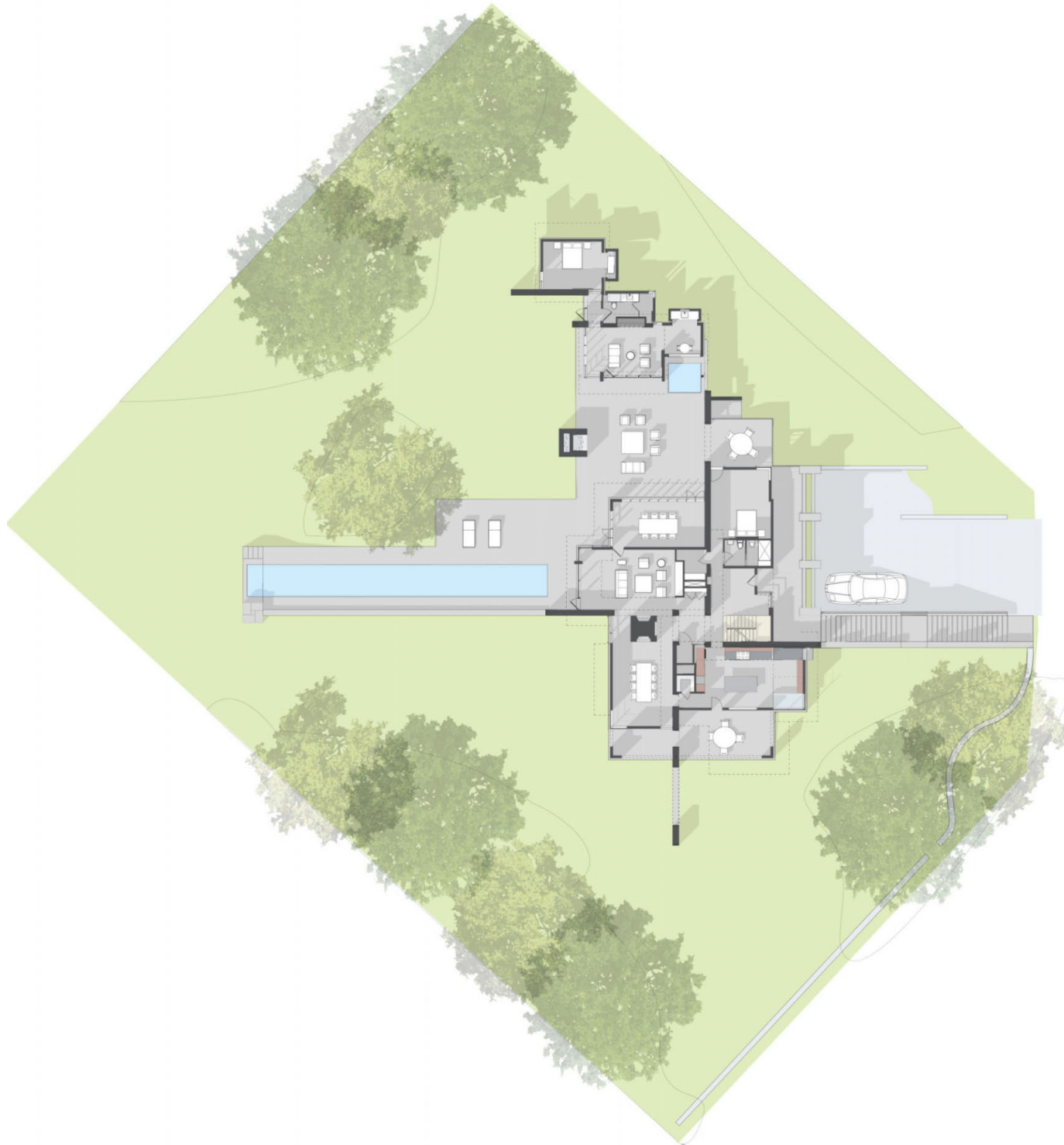





Phase 2 - Guest house, terraces, lap pool

Phase 1 - House completed 10 years ago



New lap pool



New guest house



First Phase /Original Project

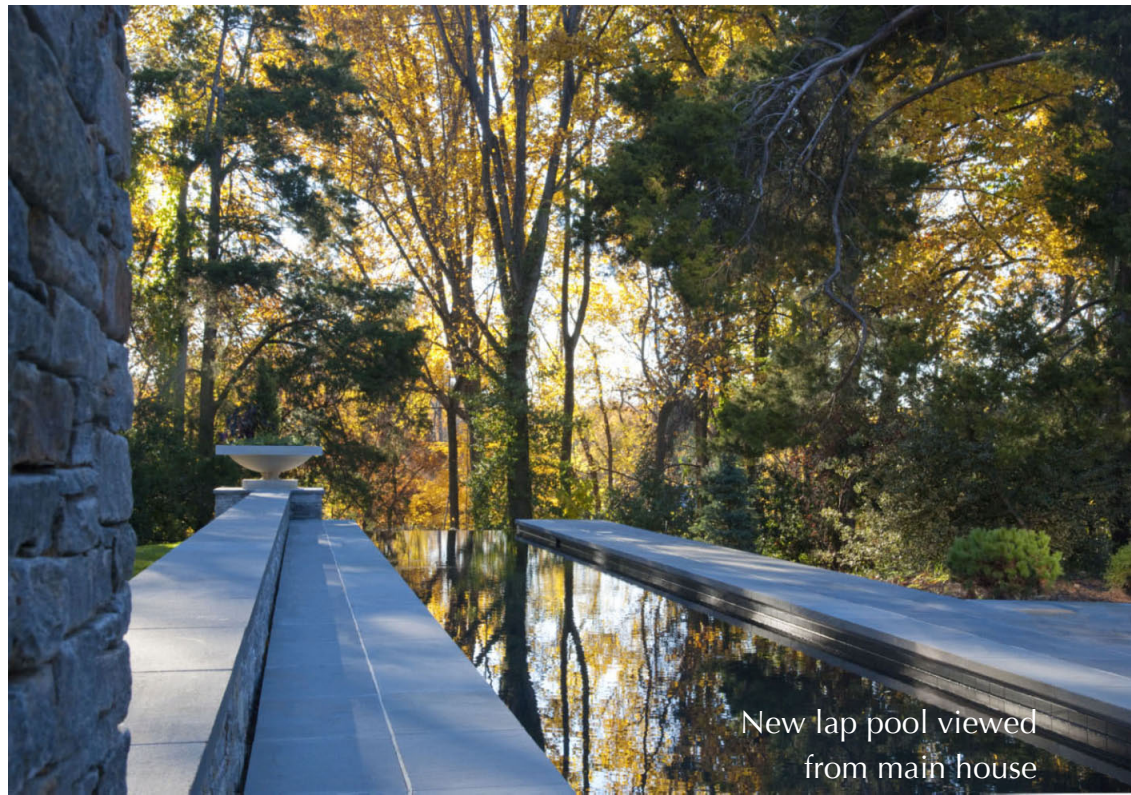

New lap pool viewed from main house





