

Interior Architecture

AIA Potomac Valley Design Awards Category

Renaissance Edmonton Airport Hotel

4236 36th Street East

Edmonton International Airport, Alberta T9E 0V4 Canada

Edmonton is the gateway to the Northwest Territories; land of the oil sands. It is a remote, cold place, with vast resources. It is a place where boots, plaid shirts and jeans are the norm and pickup trucks are the transportation.

The airport in Edmonton was transformed into an international hub and the Renaissance Edmonton Hotel has become its crowning jewel. The exterior of the Renaissance Edmonton is sweeping and modern with a playful rhythm of colored fins. The interior design reflects the aesthetic of the exterior, while drawing inspiration from airplanes and air flight. References to snow and ice and mountain topography in the finishes provide the final connection to the Edmonton region.

A combination of curving wall planes, freestanding pavilions, and millwork screens define different zones of activities within the lobby. The heart of the space is defined by the natural wood surface of a floor, which becomes a wall, which becomes the bar, culminating in a live edge natural wood bar top.

Other features include a private lounge which feels like the inside of an airplane with views of local Elk Island, oil rig patterned chairs, and bathrooms inspired by bubbling black oil. Nestled in a quiet corner is the library. With grey wood floors, comfortable seating groups, and book and artifact filled millwork the library is a cozy respite.

A place to stay, a place to play,
A place for rest, a place for progress,
A place to meet, a place to greet,
A place for fun, a place when there's no sun.



RENAISSANCE HOTEL



Airport Entrance

From the airport, Guests are teleported through a modern gateway, through a sweeping pedway accented by glowing fins, into the arcade. The arcade is a grand promenade which connects the restaurant, retail, and the main lobby.

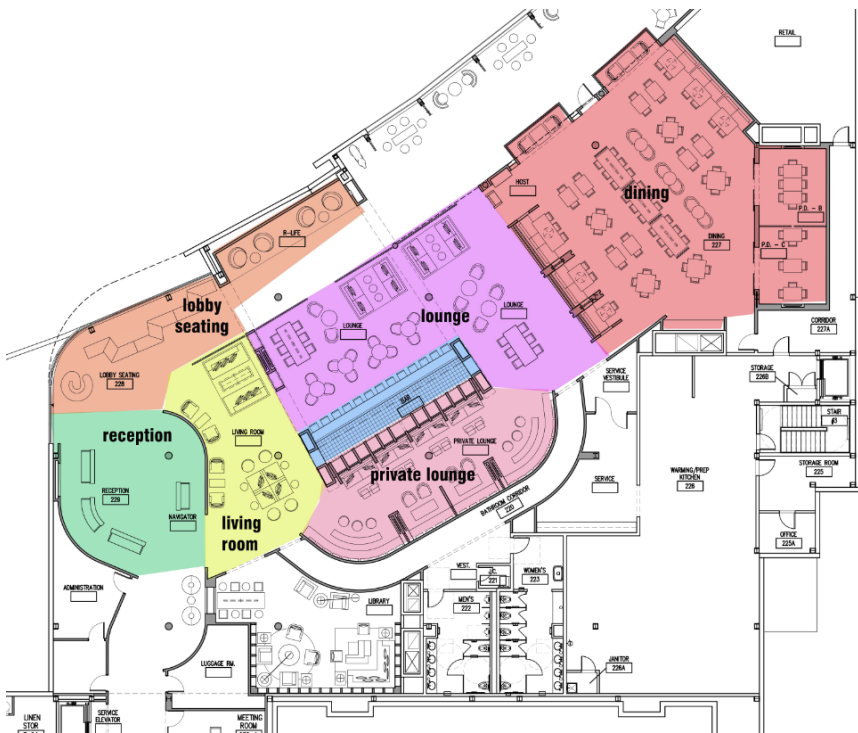



Reception Area

Backlit modern reception pods bring Guests in for a landing, while a playful furniture garden keeps the kids entertained.



Restaurant Dining

The heart of the hotel is the Lounge and Bar area. Warm woods and glowing elements create hearth-like spaces while other elements remind us of the airplane we arrived on.





Public Lounge

Jazzy and cool, this area is set for music and entertainment. Even the lights are dancing.

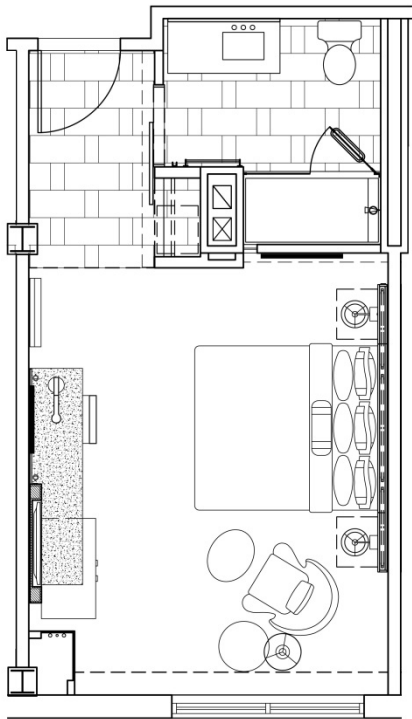

Guestrooms

Cool colors and fractal patterns make light play of this cold northern location. Jean butt patterns in the bathroom remind of local manufacturing history.

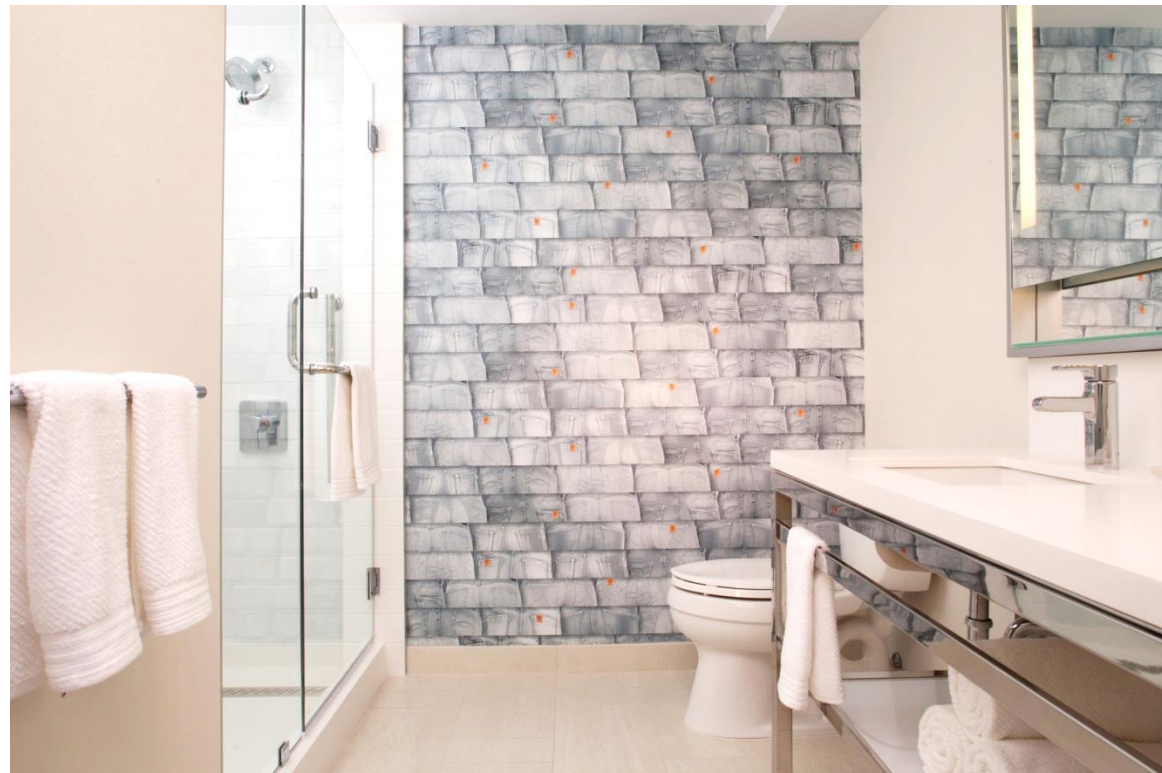



Lounge

Textured leather, raw metal and mid-century modern elements evoke a warm and nostalgic feeling of planes and pilots.

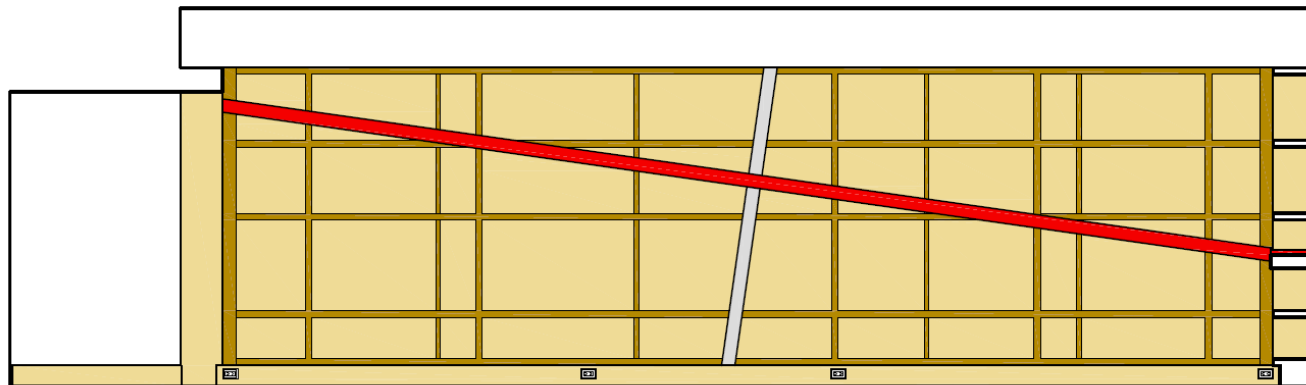

Custom Casework

Warm and cozy, the millwork in this central Library space takes its cue from an airport radar screen. The shelves are decorated with souvenirs from around the world as if it were a shared living room for all its visitors.



Womens Restroom

Sexy and mysterious, this Restroom reminds us of the unique, glamorous and jet setting lifestyle that it's guests enjoy. Vanity mirror bubbles like oil to remind Guests of an influential local resource.