PROJECT NAME

Johns Hopkins University FastForward East

PROJECT LOCATION

Baltimore, MD

PROJECT CATEGORY

Architectural Design Awards / Higher Education

PHOTOGRAPHY CREDITS

© Alan Karchmer

To support local start-ups and drive more economic development in Baltimore, Johns Hopkins University opened FastForward East, their newest innovation hub.

With a short timeline, a complex set of stakeholders, and a modest space to work with, the design team focused on bolstering rentable square footage, providing open and collaborative settings that support a variety of events, and using scale, finishes, and materials to bring attention to the activity inside.

The program features 6,000 sf of office space, a shared conference room, common room, and kitchen, as well as two wet labs equipped with plumbing, ventilation, and the latest equipment for hands-on scientific research.

Upon entering the space, there is large-scale custom art piece hanging over the coffee bar and pantry area. A reception stand, casual furniture, and open co-working desks share the front entry space. A conference room tucks under the mezzanine along with four offices to maximize open space and flow in the small footprint.

A counter along the window frontage by the offices provides an opportunity for office dwellers to spill out or present marketing materials. Additional larger offices and open desks are located on the second floor for larger start-ups. It was important to maintain a strong connection to the Atwaters café next door in order to showcase Fast Forward space to customers and as well as provide an amenity for the start-ups.

A bright orange stair, birch plywood office fronts, and raw concrete floors keep the space feeling industrial but tailored. Writeable surfaces are located throughout, indicated by green walls in each of the offices and white walls in the conference room and mezzanine. Chalkable doors provide another opportunity to personalize the space and highlight the companies within. Even the surface of the millwork in the pantry is an opportunity to leave messages, share information, and quickly ideate with a group.

A rotating, four-quadrant custom art piece by local artists Jessie and Katey is a highlight; it brings an energy and excitement that is visible from the street and incorporates the colors used throughout the design. Neon letters light the end of the north wall with “Lets Do This” as a mantra and reminder for entrepreneurs and innovators. Powered stations connect into a ceiling mounted cord reel and keep the light industrial feel consistent.

Hopkins called for signage to co-exist in the space for both JHU Technology Ventures and Fast Forward. The team responded with a hyper-scaled Fast Forward on the Wolfe Street frontage, and JHU Technology Ventures on the Ashland Avenue frontage. Overall, the expansion of the FastForward accelerator program demonstrates Johns Hopkins' commitment to innovation and life-changing technologies to not only the university, but also to the city of Baltimore.



let's
do
this

Main Workspace from Entry

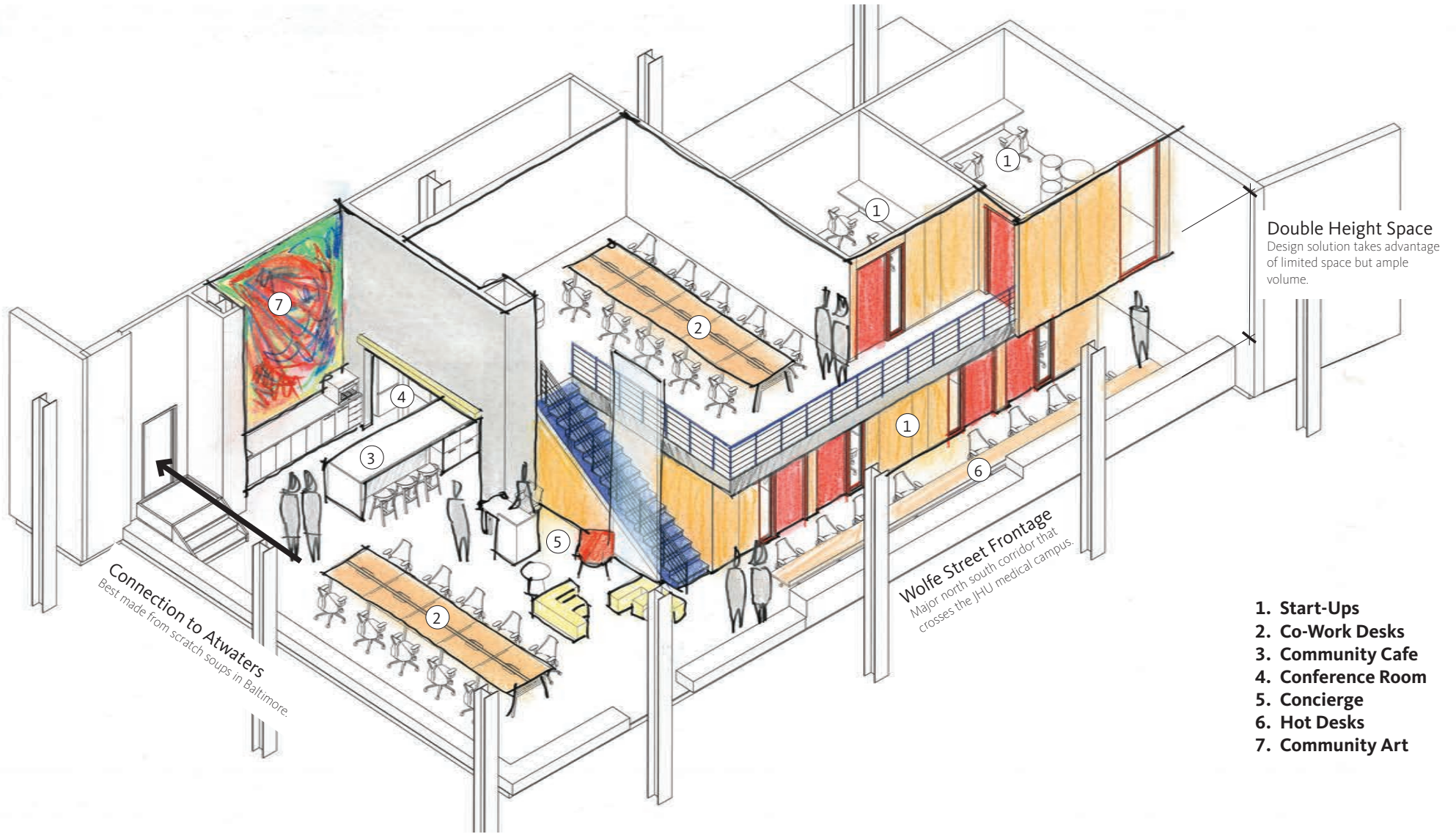

Double Height Space
Design solution takes advantage of limited space but ample volume.

Connection to Atwaters
Best made from scratch soups in Baltimore.

Wolfe Street Frontage
Major north-south corridor that crosses the JHU medical campus.

- 1. Start-Ups
- 2. Co-Work Desks
- 3. Community Cafe
- 4. Conference Room
- 5. Concierge
- 6. Hot Desks
- 7. Community Art



Pantry Detail



*View to Office from
Mezzanine*



PLEASE NOTE:
The WiFi PW
changed as of 5/15

View from Entry to Pantry



Work Stations



Exterior Storefront

