

# Noblis Headquarters

Reston, Virginia

Project Category: Interior Architecture



# Noblis Headquarters

Reston, Virginia

Project Category: Interior Architecture

Noblis, a nonprofit science, technology and strategy organization, was in need of a new headquarters that would reinforce the creation of the knowledge, innovation and collaboration they bring to their federal clients.

In keeping with its culture and value of exploration, Noblis took the opportunity to challenge the way they work. They set goals to break out of their normal work habits, and envisioned their new office as a physical network which parallels the virtual network of their data-driven research and development.

When analyzing how work is done at Noblis, the depth of departmental interconnections was much greater than they first thought. This became an opportunity to completely transform their work environment.

The design team embraced the angles of the base building, creating connections and nodes along a non-orthogonal path. This breaks up the floorplate into smaller neighborhoods that are buffered with public/collaborative spaces.

It was important to have a welcoming environment for staff and visitors. Noblis wanted people to see one another and have easy access to a variety of meeting spaces with integrated technology for a fast and efficient workflow. Labs and presentation spaces are showcased on the main level and situated along the main path of circulation giving Noblis the opportunity to share their work with visitors.

*The depth of departmental interconnections was much greater than they first thought. We applied this concept architecturally, and the network of spaces took form.*

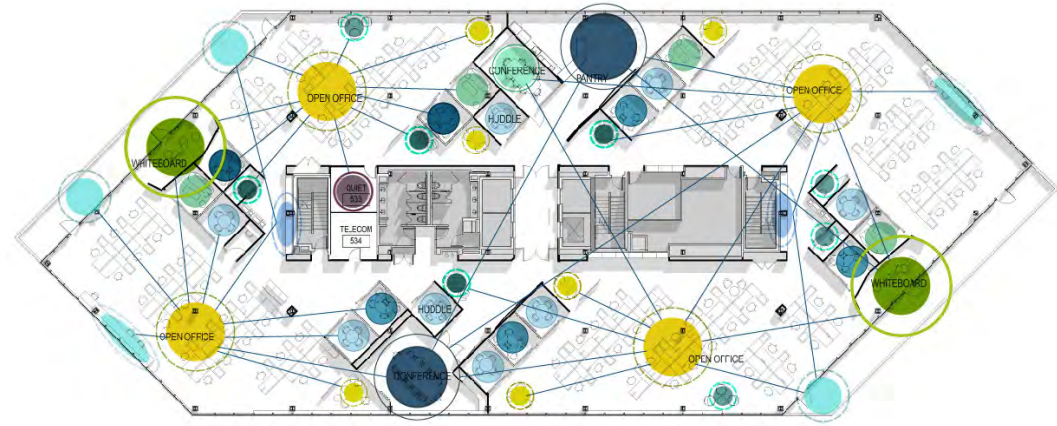

Typical Floor

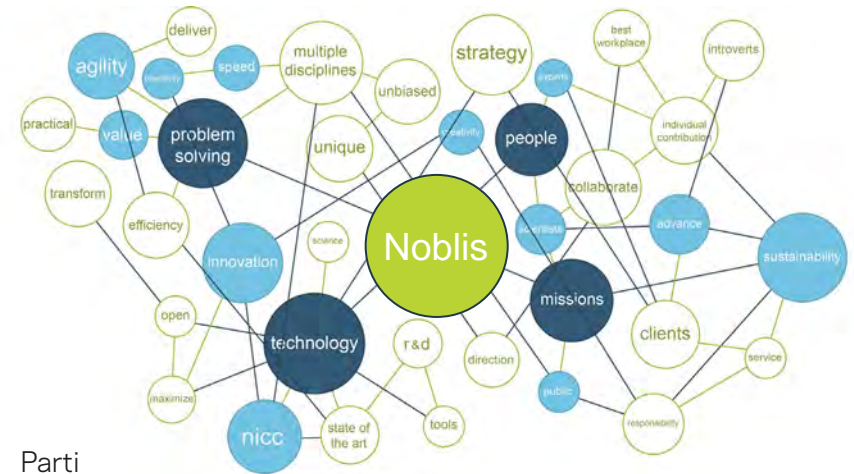

Parti



First Floor



## Neighborhood

Dividing the floors into smaller neighborhoods provides an efficient way for people to connect with one another at a more manageable scale. A variety of huddle rooms and breakout spaces are directly adjacent to workstations to offer choice of space for the activity at hand.





Formal meeting spaces are interspersed in the neighborhoods while nooks provide space for serendipitous interaction. Public spaces are defined by carpet and ceiling transitions. Custom shelving at workstations are a subtle cue for privacy and heads-down work.



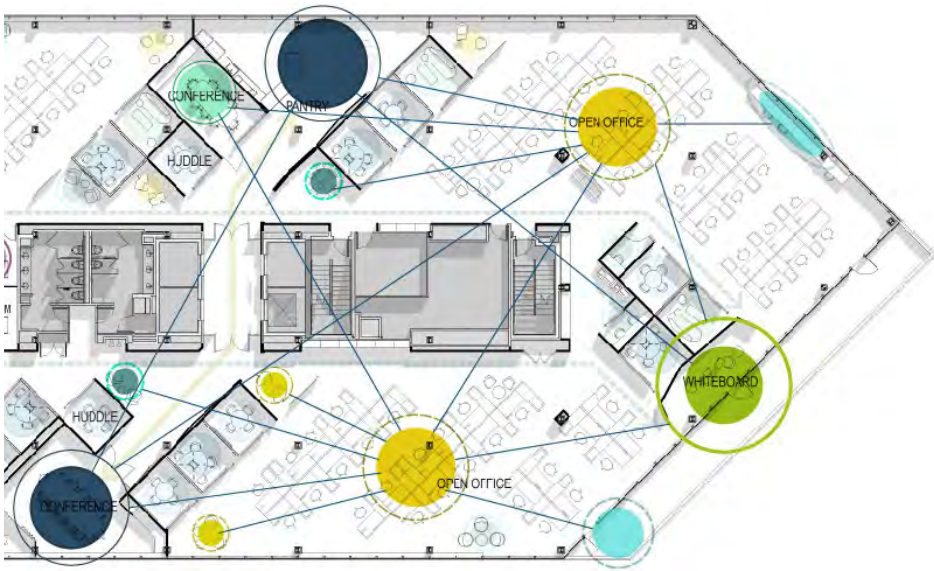

## Shared Amenities

Public spaces, like the pantry, conference rooms, and white board areas, are nodes capping the ends of the main pathways. Their centralized location allow easy access from any neighborhood on the floor, creating another opportunity to bring people together.





The “Caves” on each floor are used for daily scrums or as a war room for longer term pursuits. The spaces also provide terrace access for collaboration both inside and out.



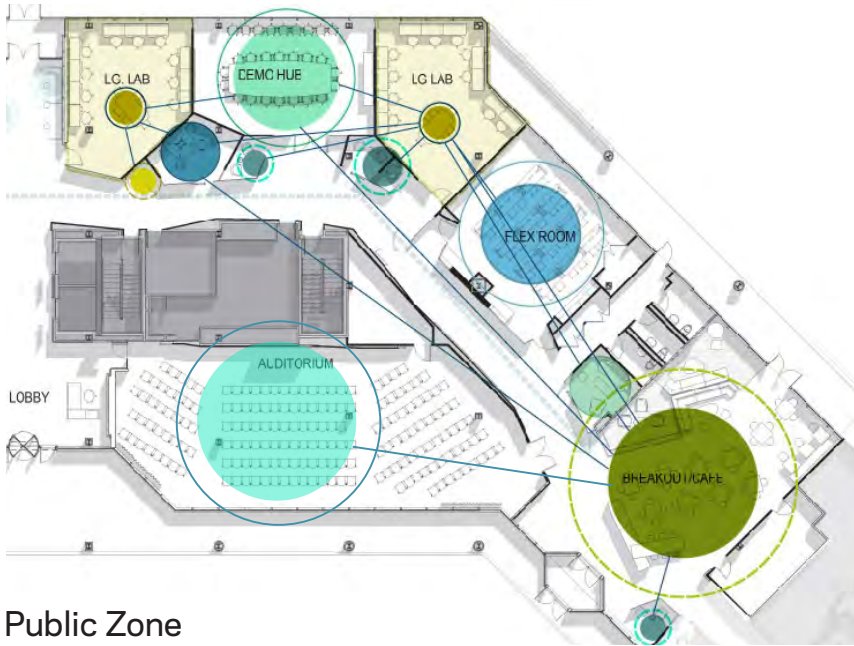

## Public Zone

The main floor is for all staff to use, and consists of a café, training room, and 200-seat auditorium. The café is designed to support a variety of functions and gives staff another work setting away from their desks on the upper floors. Not only the primary social space, the café accommodates internal and external presentations.





Custom veneer wall covering and a continuous linear light denote the main circulation. Smaller activity spaces are located along the path while larger social spaces are nodes at each end.





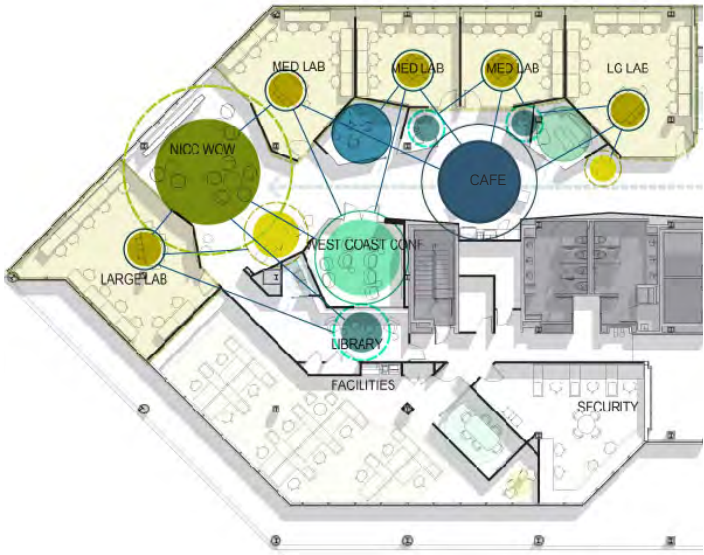

**Incubator**

The private side of the main floor consists of labs as well as flexible collaboration and presentation areas. The labs are visible from the main path showcasing their work to clients and other Noblis staff. Smaller rooms with soft seating give lab users multiple options for activities throughout the day.





The showpiece at the end of the main path consists of three meeting areas: a casual conference room, a white board area, and an open brainstorming space. While the wood soffit and flooring define the conference and white board area, the glass walls maintain a visual connection reiterating the idea of the larger network.

